

M903

DIY mini house kits – Houguang Studio











M903 Instruction manual

NOTICE OF ASSEMBLE

Tips for assembling

1. Pictures shown on the package may be slightly different from the actual product.
2. All the materials are taken in the operation step, put the remaining materials back into the original pocket until the installation is completed. (Avoid material loss during installation)
3. The dimensions indicated in the step diagram are "cm".
4. If there have template paper material, please cut the material according to the template to avoid mistakes..
5. According to the part rule example at the bottom of this page, refer to the part on the part number drawing, find the material object and compare with the material list, confirm and install. (Wooden parts only)
6. Glue should not be applied too much, so as not to dry longer, overflow will affect the effect of the finished product.
7. Part shapes may differ from the photographs depending on the production batch

Product comes with tool:

- | | | | | | | | | |
|---|--|---|--|--|---|--|---|---|
| 1 | 2 | 3 | 4 | 5 | 6 | 7 | 1 | 2 |
|  |  |  |  |  |  |  |  |  |
| White glue:
It dries slowly and can paste materials firmly without trace. Can be used to paste wallpaper and printed paper. | Ruler:
For measuring materials to identify the number of materials so as to enhance work efficiency. | Scissors:
Can be used to cut printed paper, cloth, etc. | Cutter knife:
For peeling off power wire skin and cutting off materials. | Alcohol gel:
It dries fast and can paste materials firmly, but may leave some trace. Can be used to paste small metal materials and small components of furniture. | Tweezers:
For holding small materials and rolling up iron wire. | Screw Driver:
For fixing screws, mostly can be used to install doors and music components. | Drill:
Can be used to drill holes in timbers, roll up hard iron wire or fix screws. | Needle-nose pliers:
For cutting, bending wire, folding harder material |

How to assemble the battery holder

1. Material and tools needed:
- Battery holder, LED bulb, tape, screw driver and 2 piece AA size battery (not provided)
2. Use screw driver and take the lid off from the battery holder.
3. Insert the battery take notes on the polarity.
4. Connect the red wire to grey wire. Connect the black wire to white wire.
5. Wrap the exposed wire with the tapes.
6. Place the box lid and fastness with screw driver.

Example of parts rule:

A01: The parts are directly in the box.; B01: parts in bag B; C01: part in bag C, and so on.
(Note: display the printing paper A10-01 in the step: the printing paper is placed directly in the box, part number is A10-01)

Testing on LED function

Be sure to test the LED lights before making the lighting, note that the LED white wire to the negative, gray wire to the positive reference to the following figure operation test.

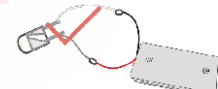
1.  **DO NOT** contact the LED wire end direct to the battery cell.
2.  Use the provide battery holder. Make sue the correct polarity.

Bring your own tools:

details of miniature kit

Name	Material package
printing paper	Bag A-A10[All printing and template papers are shown on A10 paper,total 3pieces A4]
Decoration	G bag +printing paper
Bass guiter	B bag+F bag + printing paper
Roof light	B bag +F bag+G bag +H bag
Table	B bag +F bag + printing paper
Radio & Earphone	B bag +F bag +G bag + printing paper
Tambourine	B bag + printing paer
Sofa	B bag +F bag +G bag
Big flower pot	B bag +F bag +G bag + printing paer
Steps	B bag
Fence	B bag
Small chair	C bag
Audio	C bag+F bag +G bag + printing paper
Cabinet	C bag+F bag + printing paper
Rack drum	C bag+F bag+G bag + printing paper
Flower pot	C bag+F bag+G bag
Round stool	D bag
Microphones and signs	D bag +F bag+ printing paper
Box and small table	D bag +F bag+G bag + printing paper
Door and window	D bag+F bag+ printing paper
Bay Window	E bag
Lintel	E bag
White french window	E bag
Outer frame	A bag+D bag+E bag
Outer frame	A bag+E bag
Plant	F bag+G bag+H bag+ printing paper
Light	F bag+G bag+H bag
Guzheng	D bag+F bag+ printing paper
Battery holder	H bag
Dust cover	J bag

Thumbnail of material list (reference only)



Thumbnail of printing paper & template paper (reference only)



Symbol description used

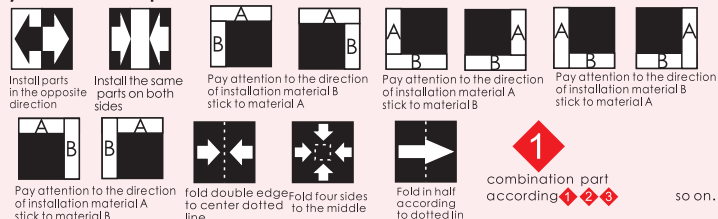

Decoration

Welcome to DIY house world!

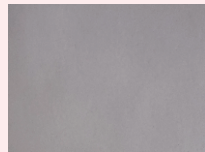

G05



A10-01



G05



Cut out A10-01 and stick to G05 according to the template, then cut out 4

Bass guitar

please follow me slowly!



A10-05-01



B19

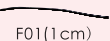

A10-05-02

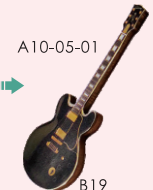

B19



A10-05-02

Roof light

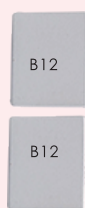

B12



B11



F15 (0.8cm)



G06 (some)



F08 (some)



G07 (some)



H01



A10-05-02



B11 B12

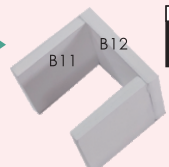

B11 B12



A10-05-02

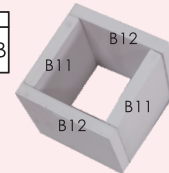

B11 B12

F08 (Cut off a quarter of it)



F15: 0.8cm

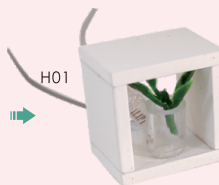

H01



G06 G07

Table



3



B06

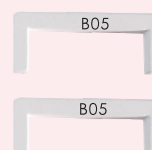

B05

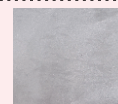

F12 (1.4*2.5cm)



F05 (3cm)



F08 (some)



F15 (1cm)

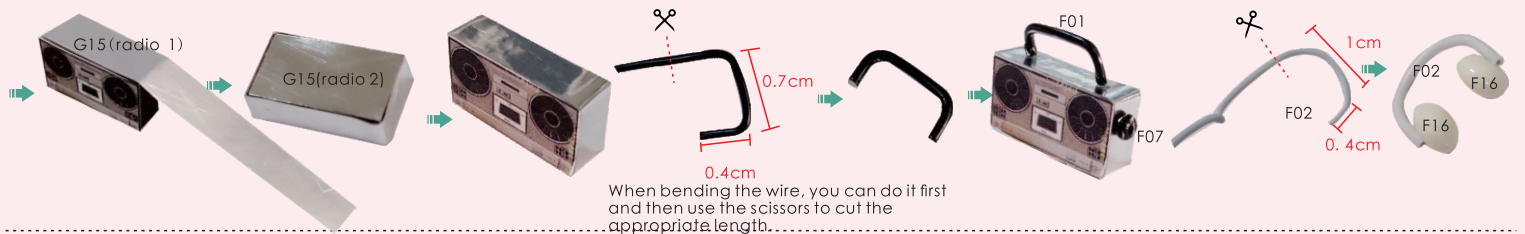
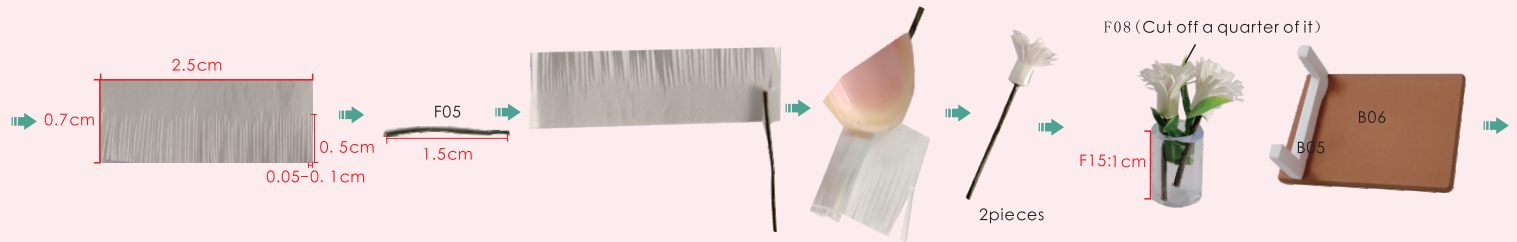

Sofa



Be patient! I'm sure you can.

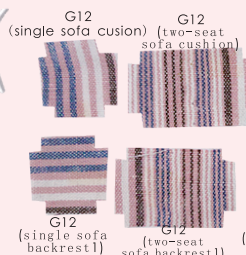

Cut out the material G12 and F10 according to the template paper before making.

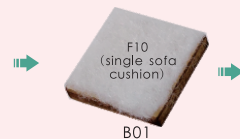

Trim the edges with scissors, as below shown.

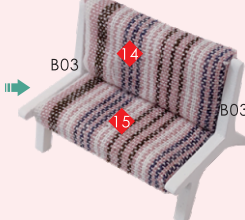
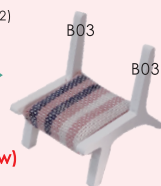

Big flower pot

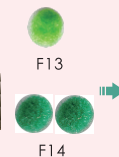
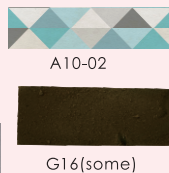
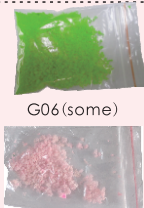
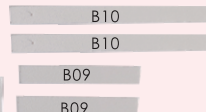
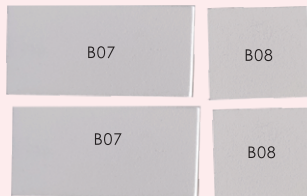

Cut out the material G05 according to the template paper before making.

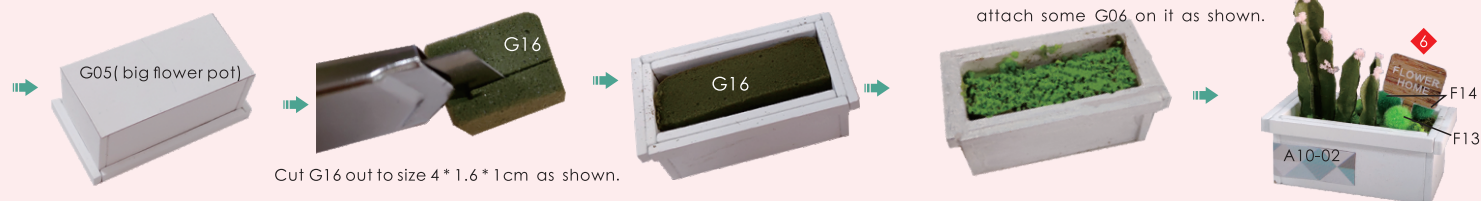
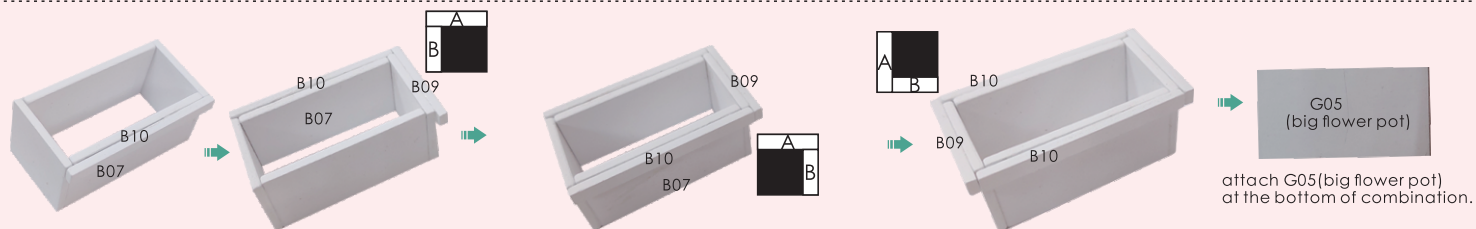
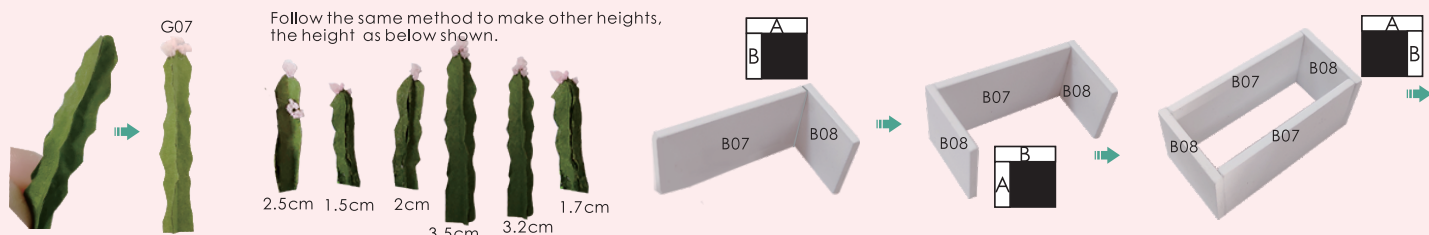
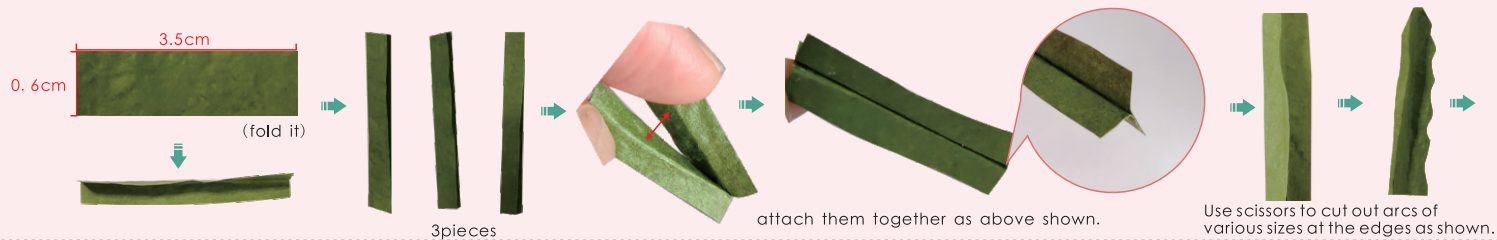

Steps

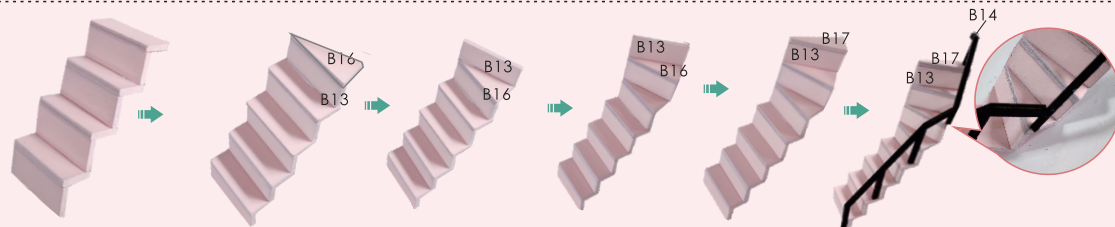
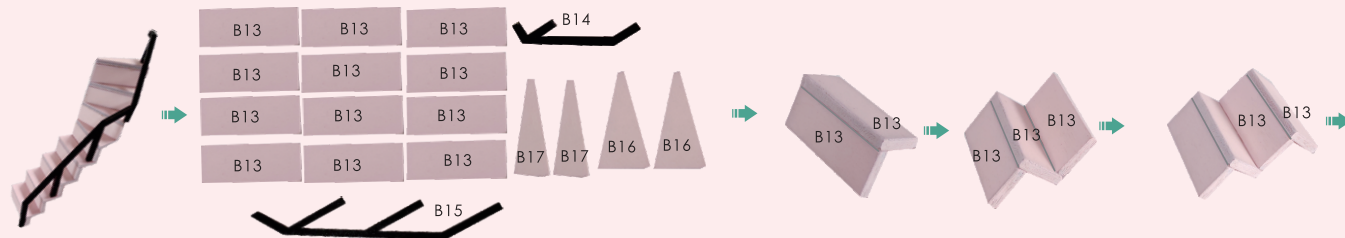

Small chair



Keep it up!



Audio



Cut out the material G15 according to the template paper before making.

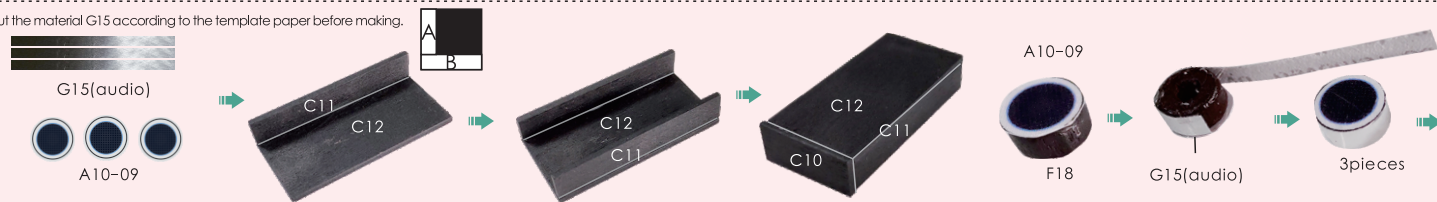

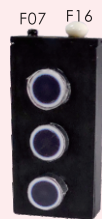

Cabinet



F01(1.5cm)

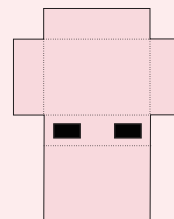

A10-06

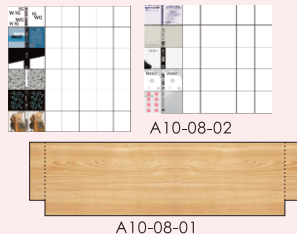
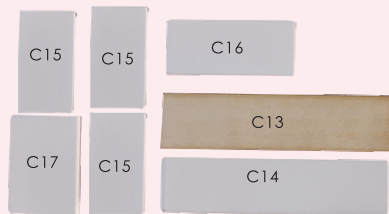

2pieces

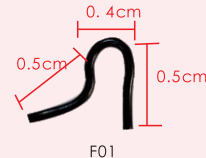
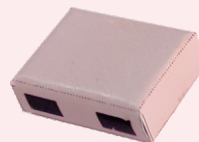
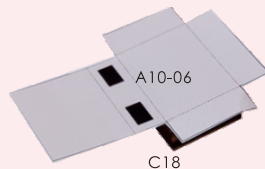
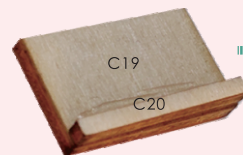

fold A10-08-02 in a "Z" form according to the line.



F07

If the wire doesn't fit into the bead hole, glue it together



F07

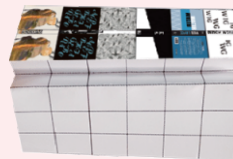

Glue the inside of the book.

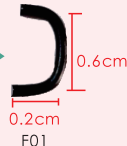
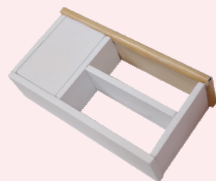
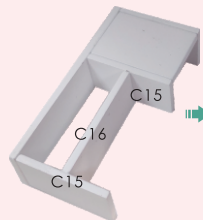
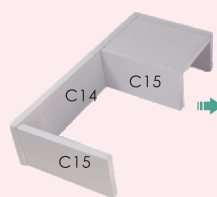
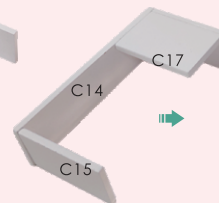
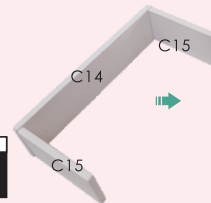
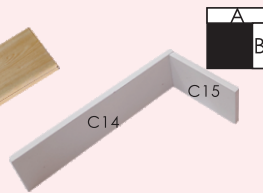
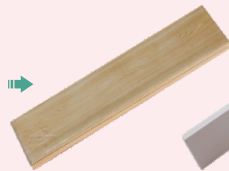
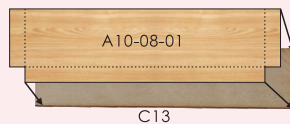

Rack drum

Patience and perseverance can help you do better.!

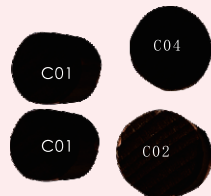

Cut out the material G15 according to the template paper before making.

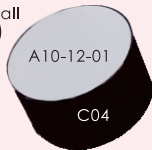
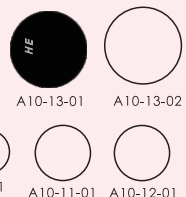
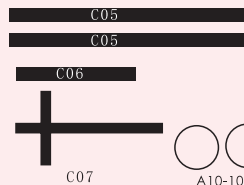
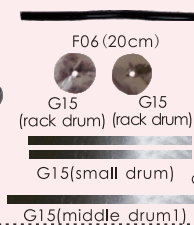

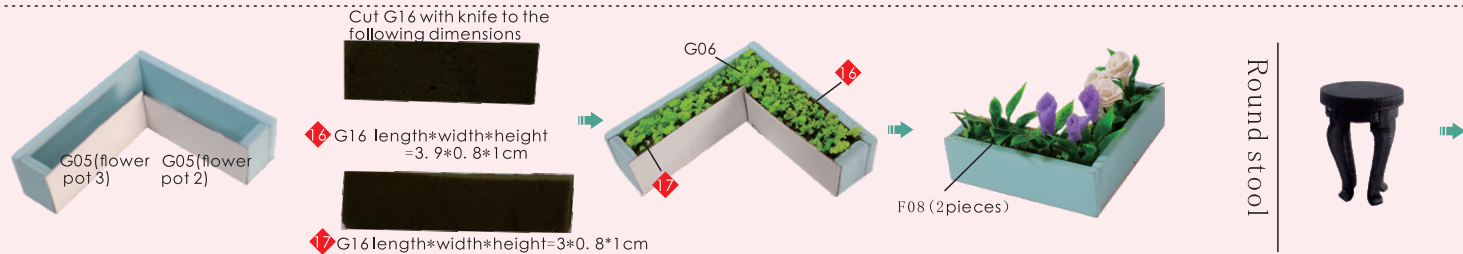
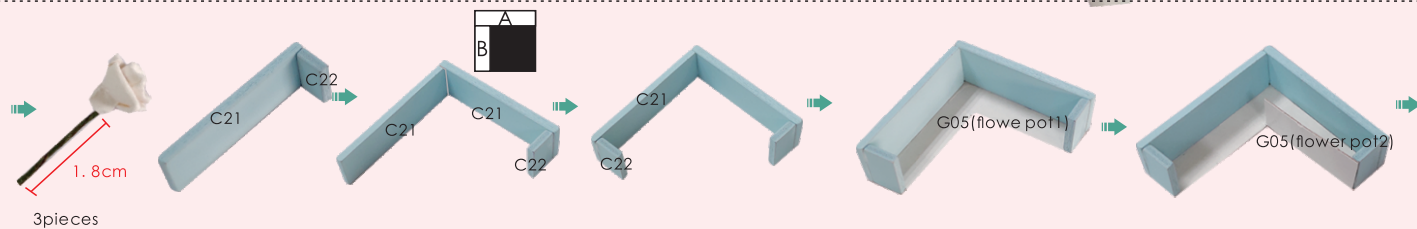
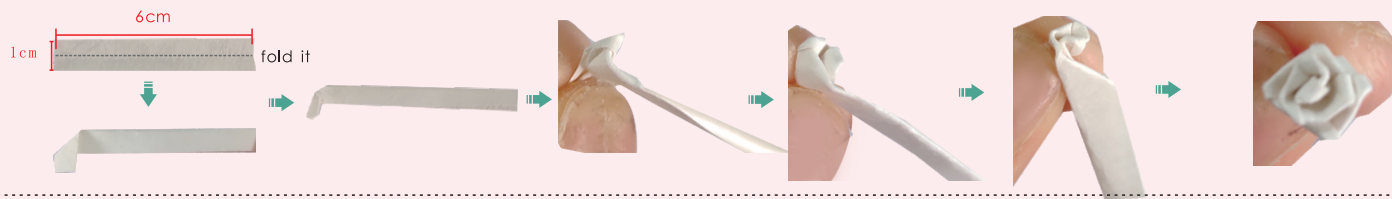

Microphones and signs

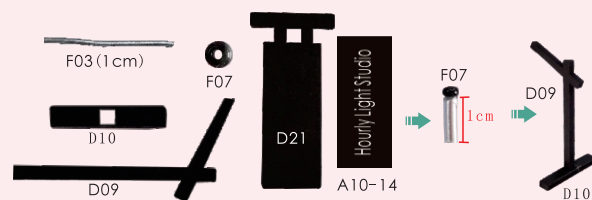

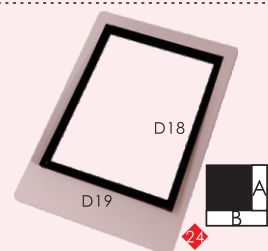
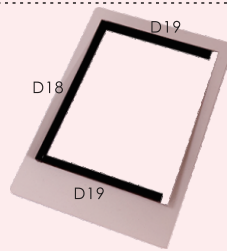
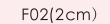
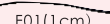
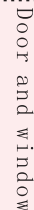
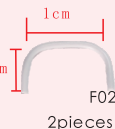
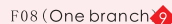
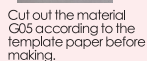
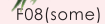
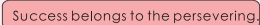
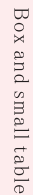

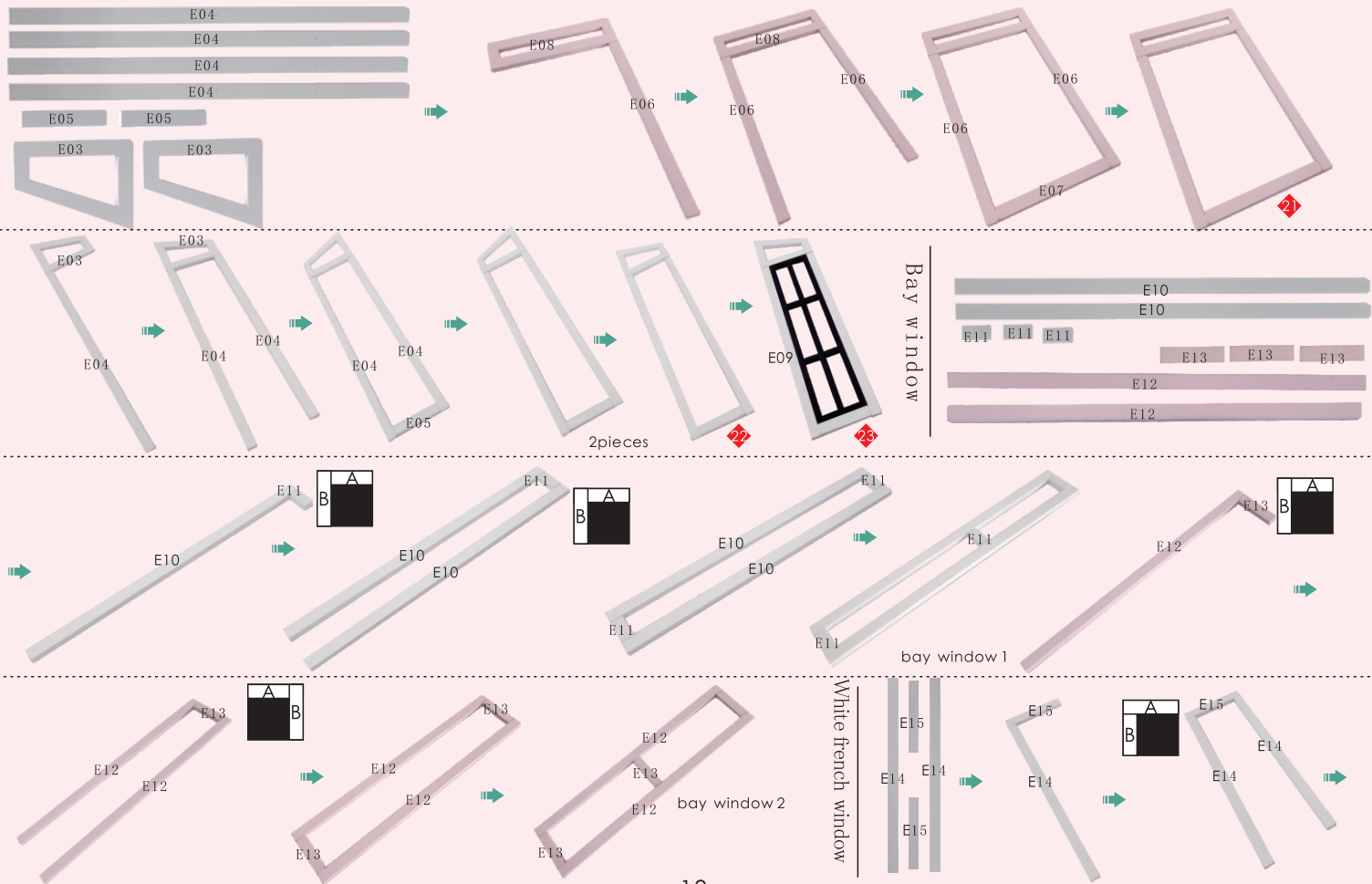

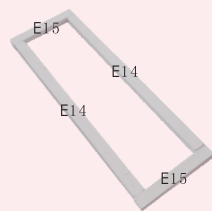

Outer Frame Component

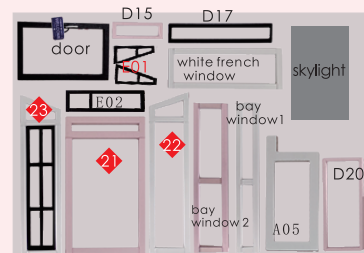
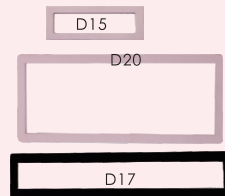
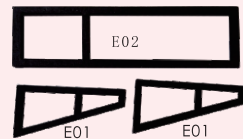

A part that has been partially made (Please refer to page 17 for the production of A05), as shown on the A08 PVC film, then cut out with scissors.

A08

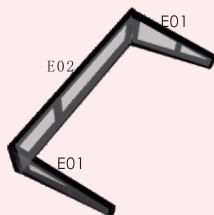
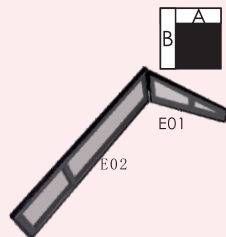

Please refer to the lamp below before gluing

skylight

door

Light





Vine

Gu zheng



Come on! It's almost finished!!



D04

D04

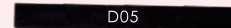

D05



D07



D08



D06



A10-20



A10-20

Note: When pulling the string, you can straighten the wire and glue it after twisting the block.

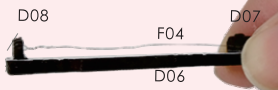

A10-20



Outer frame



A10

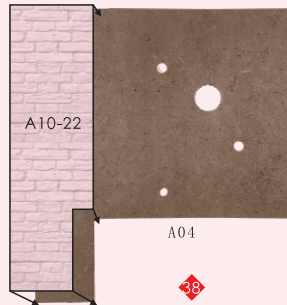

A10-22

A04



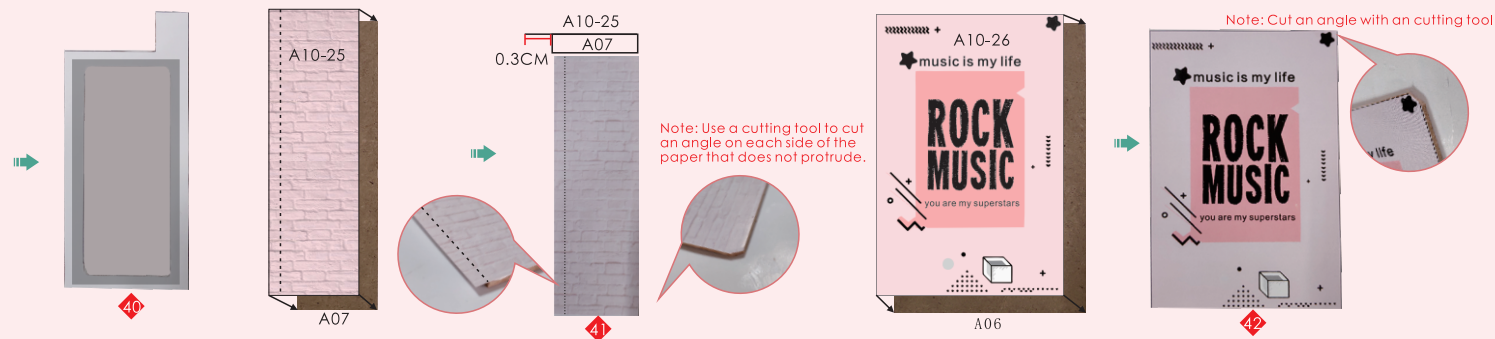
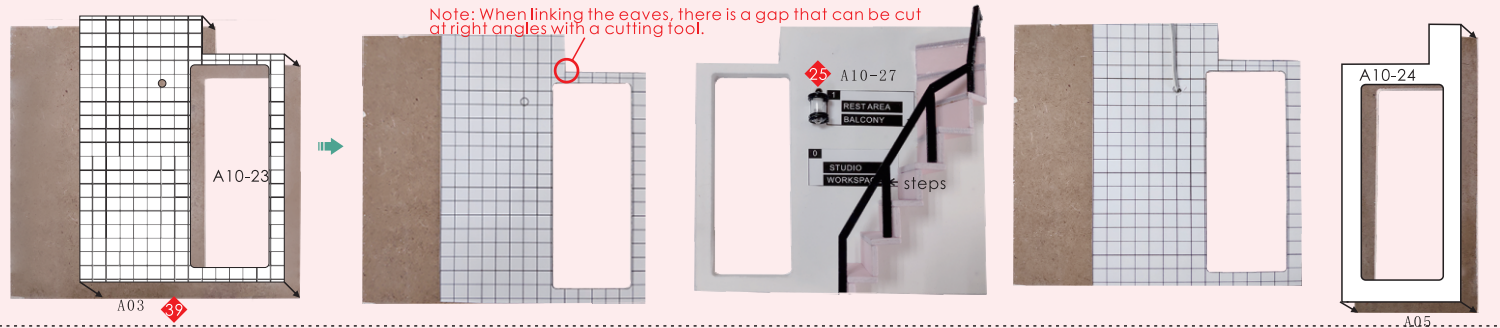

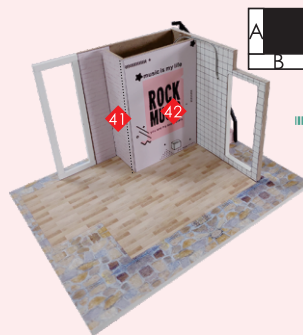
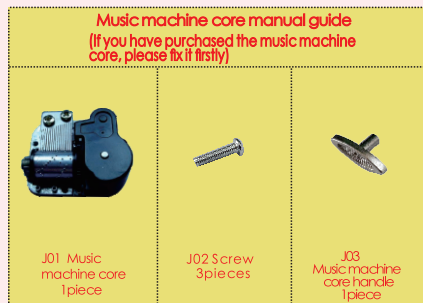

A10-28



skylight







Statement: the lamp wires cannot be inserted into the output socket.

- Can use 7 batteries
- Please notice the place of anode and cathode when pit in the batteries
- Rechargeable batteries are not blunt electricity
- Rechargeable batteries can only be charged under adult supervision
- Rechargeable batteries should be removed from the toy before charging
- Different types of batteries cannot mix;
- Do not mix new batteries in use with semi-used batteries.
- Run out of battery should be removed from the toy
- The power shall not be short circuit



Trim all the LED wiring to the same length.

Use a craft blade to carefully skim over the plastic to bare the copper wire. Twist the same color wire together.

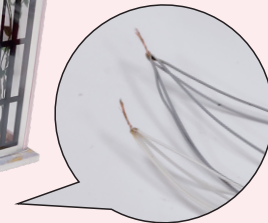



Twist the following wire together:
 (I) BLACK wire from the Battery box with the WHITE wire from LED bulb.
 (II) RED wire from the battery box with the GREY wire from LED bulb.

Roll and seal the duly twist copper with the white tape H03 provided.

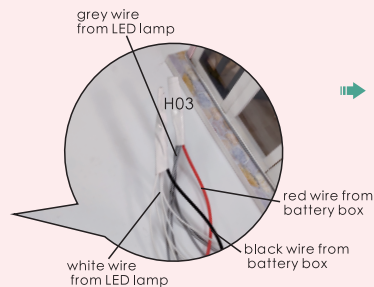

Place the battery box in the allocated space.

Installation of dust proof cover
 (For updated version, the parts need to be purchased separately)

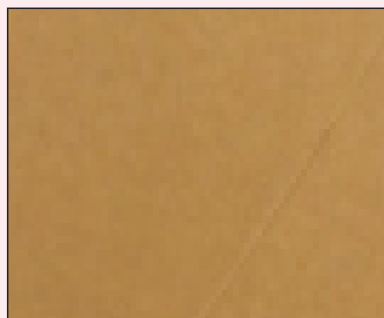

scale 1:4
 J04 Transparent cover
 20*16.5*0.18cm
 2pieces

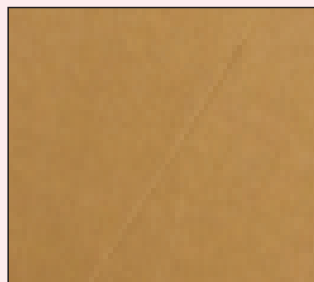

scale 1:4
 J05 Transparent cover
 16.5*14.64*0.18cm
 2pieces
 21

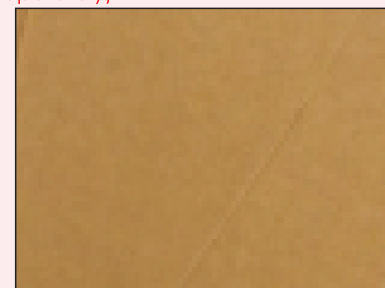

scale 1:4
 J06 Transparent cover
 20*15*0.18cm
 1piece



1. Tear off kraft paper of each piece of transparent cover.

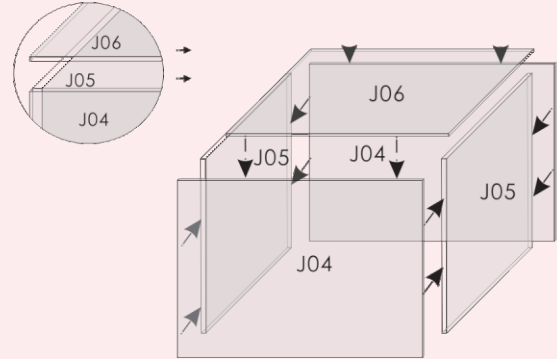

2. Paste J04, J05 and J06 together to complete the dust proof cover as shown.



Photo gallery

Photo of Dust proof cover



Photo gallery



Attention: Please keep the instruction for future enquires after installation.